

Halsflanger

000621.xxx

Produceret iht. EN 1092-1, Type 11 (eller DIN 2631)
 Pakflade Type B1 (se nedenfor)
 Kvalitet: P250GH iht. EN 10222
 Tryktrin: PN 6

Kan leveres med certf. iht. EN 10204/3.1, samt PED

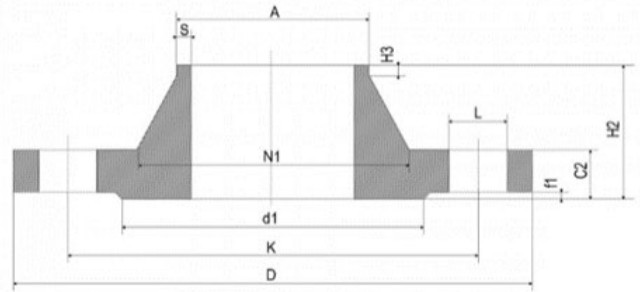

VVS nr.	DN	A	D	K	L	H3	C2	d1	f1	H2	S	Kg									
000621020	15	20,0	80	+/- 2,0	55	+/- 1,0	11	+ 1,0/0	6	+/- 1,5	12	+1,0/-1,3	2	0/-1,0	30	+/- 1,5	2	+1,0/0	0,41		
000621021	15	21,3	80		55		11		6		12		40	2		30		2		0,41	
000621025	20	25,0	90		65		11		6		14		50	2		32		2,3		0,62	
000621027	20	26,9	90		65		11		6		14		50	2		32		2,3		0,62	
000621030	25	30,0	100		75		11		6		14		60	2		35		2,6		0,76	
000621034	25	38,0	100		75		11		6		14		60	2		35		2,6		0,76	
000621038	32	38,0	120		90		14		6		14		70	2		35		2,6		1,11	
000621042	32	42,4	120		90		14		6		14		70	2		35		2,6		1,11	
000621045	40	44,5	130		100		14		7		14		80	3	0/-2,0	38		2,6		1,26	
000621048	40	48,3	130		100		14		7		14		80	3		38		2,6		1,26	
000621057	50	57,0	140		110		14		8		14		90	3		38		2,9		1,43	
000621060	50	60,3	140		110		14		8		14		90	3		38		2,9		1,43	
000621076	65	76,1	160		130		14		9		14		110	3		38		2,9		1,77	
000621089	80	88,9	190		150		18		10		16		128	3		42		3,2		2,88	
000621108	100	108,0	210		170		18		10	+/- 2,0	16		148	3		45	+/- 2,0	3,6		3,41	
000621114	100	114,3	210		170		18		10		16		148	3		45		3,6		3,41	
000621133	125	133,0	240		200		18		10		18		178	3		48		4	+1,5/0	4,65	
000621140	125	139,7	240		200		18		10		18		178	3		48		4		4,65	
000621159	150	159,0	265		225		18		12		18		202	3		48		4,5		5,50	
000621168	150	168,3	265		225		18		12		18		202	3		48		4,5		5,50	
000621219	200	219,1	320	+/- 3,0	280		18		15		20	+/- 1,5	258	3		55		6,3		8,60	
000621273	250	273,0	375		335		18		15		22		312	3		60		6,3		11,70	
000621324	300	323,9	440		395		22		15	+/- 3,0	22		365	+3,0/-1,0	4	0/-3,0	62	+/- 3,0	7,1		15,30
000621356	350	355,6	490		445		22		15		22		415	4		62		7,1		20,30	
000621406	400	406,4	540		495		22		15		22		465	4		65		7,1		23,10	
000621508	500	508,0	645		600		22		15		24		570	4		68		7,1	+2,0/0	30,80	
000621610	600	610,0	755	+/- 5,0	705		26		16		30		670	5	0/-4,0	70		7,1		44,00	



Vejledende boltediagram

VVS nr.	DN	DIM	Vejl. Boltestr.	Antal hut	Varenr. Elgalv. Bolt	Varenr. Elgalv. Møtrik	Varenr. Elgalv. Skive	Varenr. Elgalv. Boltesæt 4 bolte + 4 møtrikker + 8 skiver	Varenr. Varmgalv. Bolt	Varenr. Varmgalv. Møtrik	Varenr. Varmgalv. Skive	Varenr. Varmgalv. Boltesæt 4 bolte + 4 møtrikker + 8 skiver
000621020	15	20	M10x45	4	525304101	525305382	525315907		525304427	525305406	525315930	
000621021	15	21,3	M10x45	4	525304101	525305382	525315907		525304427	525305406	525315930	
000621025	20	25	M10x50	4	525304102	525305382	525315907		525304428	525305406	525315930	
000621027	20	26,9	M10x50	4	525304102	525305382	525315907		525304428	525305406	525315930	
000621030	25	30	M10x50	4	525304102	525305382	525315907		525304428	525305406	525315930	
000621034	25	38	M10x50	4	525304102	525305382	525315907		525304428	525305406	525315930	
000621038	32	38	M12x50	4	525304119	525305384	525315909		525304436	525305407	525315931	
000621042	32	42,4	M12x50	4	525304119	525305384	525315909		525304436	525305407	525315931	
000621045	40	44,5	M12x50	4	525304119	525305384	525315909		525304436	525305407	525315931	
000621048	40	48,3	M12x50	4	525304119	525305384	525315909		525304436	525305407	525315931	
000621057	50	57	M12x50	4	525304119	525305384	525315909		525304436	525305407	525315931	
000621060	50	60,3	M12x50	4	525304119	525305384	525315909		525304436	525305407	525315931	
000621076	65	76,1	M12x50	4	525304119	525305384	525315909		525304436	525305407	525315931	
000621089	80	88,9	M16x60	4	525304147	525305388	525315913		525304452	525305408	525315933	
000621108	100	108	M16x60	4	525304147	525305388	525315913		525304452	525305408	525315933	
000621114	100	114,3	M16x60	4	525304147	525305388	525315913		525304452	525305408	525315933	
000621133	125	133	M16x65	8	525304148	525305388	525315913	525326917	525304453	525305408	525315933	525326923
000621140	125	139,7	M16x65	8	525304148	525305388	525315913	525326917	525304453	525305408	525315933	525326923
000621159	150	159	M16x65	8	525304148	525305388	525315913	525326917	525304453	525305408	525315933	525326923
000621168	150	168,3	M16x65	8	525304148	525305388	525315913	525326917	525304453	525305408	525315933	525326923
000621219	200	219,1	M16x70	8	525304149	525305388	525315913	525326918	525304454	525305408	525315933	525326924
000621273	250	273	M16x70	12	525304149	525305388	525315913	525326918	525304454	525305408	525315933	525326924
000621324	300	323,9	M20x75	12	525304168	525305391	525315916	525326919	525304467	525305409	525315935	525326925
000621356	350	355,6	M20x75	12	525304168	525305391	525315916	525326919	525304467	525305409	525315935	525326925
000621406	400	406,4	M20x75	16	525304168	525305391	525315916	525326919	525304467	525305409	525315935	525326925
000621508	500	508	M20x80	20	525304169	525305391	525315916	525326920	525304468	525305409	525315935	525326926
000621610	600	610	M24x100	20	525304179	525305394	525315918		525304477	525305410	525315937	

Bemærkning

Bolt længde er vejledende, og udregnet under følgende forudsætninger.

To flanger spændt sammen med:

1 stk. bolt, 1 stk. møtrik, 2 stk. skiver, 1 stk. 2mm pakning, 5-10 mm overmål



Pakflade

Table 2 — Surface finish for jointing faces

Facing types	Method of machining	Radius of tool nose mm	R_a^a μm		R_z^a μm	
			min.	max.	min.	max.
A, B1 ^b , E, F	Turning ^c	1,0	3,2	12,5	12,5	50
B2 ^b , C, D, G, H	Turning ^c	—	0,8	3,2	3,2	12,5

NOTE For certain applications, e.g. low temperature gases, it may be necessary to stipulate closer control to the surface finish.

^a R_a and R_z are defined in EN ISO 4287.

^b Types B1 and B2 are raised face (type B) flanges with different specified surface roughness values.

^c B1 : Standard facing for all PN numbers.
B2 : Only if agreed between the purchaser and the supplier.

^d The term 'turning' includes any method of machine operation producing either serrated concentric or serrated spiral grooves.



Type B
Raised face (B1 and B2
(see Table 2))