

# SPLIT COLLAR

## For PVC and PE pipes



### Design features

- For PVC pipes according to EN ISO 1452-2
- For PE pipes according to EN 12201, DIN 8074 (thin wall PE pipes  $\leq$  SDR 17 need support liners)
- Restraint connection for two spigot ends. It can also be used as a repair coupling
- The teeth of the grip ring do not abrade the pipe. It is not necessary to chamfer the pipe
- Also suitable as transition from PVC to PE pipes

### Material | Technical features

- **Body** made of ductile iron, epoxy powder coated
- **Grip ring** made of brass
- **Bolts** made of stainless steel
- **Seal** made of elastomer

### Split collar

**No. 9240**

(pipe - pipe)

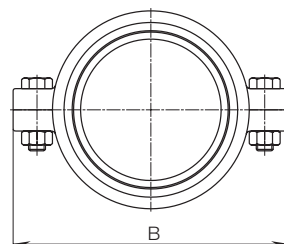
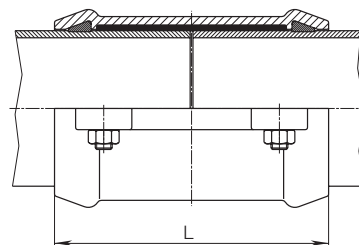

DN	ØPVC-Pipe	B	L	Weight
50	63	144	164	3,4
65	75	156	170	3,5
80	90	174	174	4,5
100	110	196	195	5,3
125	125	214	195	7,0
125	140	228	220	7,3
150	160	254	245	10,5
200	200	308	316	19,5
200	225	332	350	21,0

Order No.	Version	MOP (PN)	Dimension/DN ØPVC-Pipe								
			50 63	65 75	80 90	100 110	125 125	125 140	150 160	200 200	200 225
9240	Split collar	10									

**C 7/2**



**E. Hawle Armaturenwerke GmbH** 4840 Vöcklabruck - Austria - Wagrain Straße 13  
Tel.: +43 (0) 7672 72576 0 - Fax: +43 (0) 7672 78464 - E-Mail: hawle@hawle.at - www.hawle.com