

SYSTEM 2000

Flange for PE and PVC pipes



Design features

- With push socket for high-tensile restraint connection with PE and PVC pipes
- Flange sized according to EN 1092-2, drilled according to EN 1092-2 | PN 10 standard; EN 1092-2 | PN 16 DN 200 to DN 600 please specify on order - other standards on request
- With integrated flange seal made of elastomer

No. 0400



| Order No. | MOP (PN) | Dimension/DN | Dimension/DN | | | | | | | | | | | | | |
|-----------|---|--------------|--------------|----|----|----|-----|-----|-----|-----|-----|-----|-----|-----|-----|--|
| | | | 50 | 60 | 65 | 80 | 100 | 125 | 150 | 200 | 250 | 300 | 400 | 500 | 600 | |
| 0400 | 16 (DN 50 - DN 150) 10 (DN 200 - DN 600) | Ø pipe A | 63 | 63 | 63 | 63 | 90 | 110 | 140 | 200 | 250 | 315 | 400 | 500 | 630 | |
| | | | 75 | 75 | 75 | 75 | 110 | 125 | 160 | 225 | 280 | 355 | 450 | 560 | | |
| | | | | | | | 90 | 125 | 140 | 180 | 250 | | | | | |
| | | | | | | | | | 160 | | | | | | | |

*DN 200-600, PN 16 on request

| Flange DN | Ø pipe A | Ø D | Ø K | C | L | E | Bolts | | Weight |
|-----------|----------|-----|-----|----|-----|-----|-------|--------|--------|
| | | | | | | | Qty | Thread | |
| 50 | 63 | 165 | 125 | 19 | 90 | 80 | 4 | M 16 | 3,7 |
| 60 | 63 | 175 | 135 | 19 | 90 | 80 | 4 | M 16 | 3,8 |
| 60 | 75 | 175 | 135 | 19 | 92 | 82 | 4 | M 16 | 4,0 |
| 65 | 63 | 185 | 145 | 19 | 90 | 80 | 4 | M 16 | 4,3 |
| 65 | 75 | 185 | 145 | 19 | 92 | 82 | 4 | M 16 | 4,6 |
| 80 | 63 | 200 | 160 | 19 | 90 | 80 | 8 | M 16 | 4,7 |
| 80 | 75 | 200 | 160 | 19 | 92 | 82 | 8 | M 16 | 4,8 |
| 80 | 90 | 200 | 160 | 19 | 95 | 85 | 8 | M 16 | 5,5 |
| 100 | 90 | 220 | 180 | 19 | 95 | 85 | 8 | M 16 | 6,8 |
| 100 | 110 | 220 | 180 | 19 | 95 | 85 | 8 | M 16 | 6,3 |
| 100 | 125 | 220 | 180 | 19 | 97 | 87 | 8 | M 16 | 6,6 |
| 125 | 110 | 250 | 210 | 19 | 95 | 85 | 8 | M 16 | 7,7 |
| 125 | 125 | 250 | 210 | 19 | 97 | 87 | 8 | M 16 | 7,8 |
| 125 | 140 | 250 | 210 | 19 | 103 | 93 | 8 | M 16 | 10,3 |
| 125 | 160 | 250 | 210 | 19 | 145 | 110 | 8 | M 16 | 11,5 |
| 150 | 140 | 285 | 240 | 19 | 103 | 93 | 8 | M 20 | 11,3 |
| 150 | 160 | 285 | 240 | 19 | 115 | 105 | 8 | M 20 | 10,5 |
| 150 | 180 | 285 | 240 | 19 | 125 | 115 | 8 | M 20 | 12,5 |
| 200 | 200 | 340 | 295 | 20 | 135 | 125 | 8 | M 20 | 16,8 |
| 200 | 225 | 340 | 295 | 20 | 138 | 128 | 8 | M 20 | 18,0 |
| 200 | 250 | 340 | 295 | 20 | 225 | 145 | 8 | M 20 | 27,0 |
| 250 | 250 | 400 | 350 | 22 | 155 | 145 | 12 | M 20 | 28,4 |
| 250 | 280 | 400 | 350 | 22 | 158 | 148 | 12 | M 20 | 29,0 |
| 300 | 315 | 455 | 400 | 25 | 184 | 174 | 12 | M 20 | 43,0 |
| 300 | 355 | 455 | 400 | 25 | 277 | 237 | 12 | M 20 | 63,0 |
| 400 | 400 | 565 | 515 | 25 | 242 | 230 | 16 | M 24 | 76,5 |
| 400 | 450 | 565 | 515 | 25 | 302 | 260 | 16 | M 24 | 84,0 |
| 500 | 500 | 715 | 620 | 32 | 365 | 346 | 20 | M 27 | 144,0 |
| 500 | 560 | 715 | 620 | 32 | 450 | 372 | 20 | M 27 | 167,0 |
| 600 | 630 | 840 | 725 | 36 | 459 | 399 | 20 | M 27 | 256,0 |

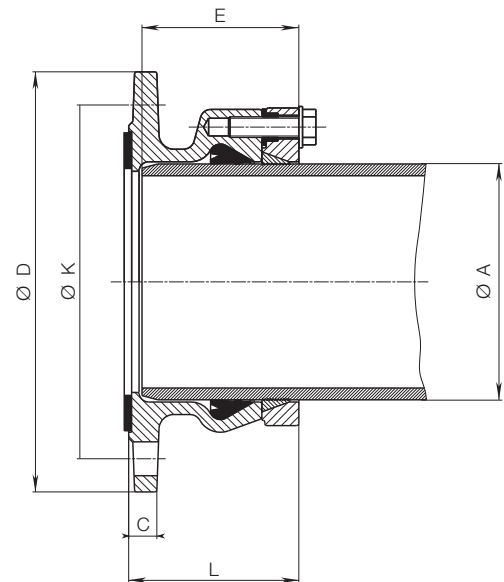

E. Hawle Armaturenwerke GmbH 4840 Vöcklabruck - Austria - Wagrainstraße 13
 Tel.: +43 (0) 7672 72576 0 - Fax: +43 (0) 7672 78464 - E-Mail: hawle@hawle.at - www.hawle.com

F 4/1