

# ISO COMBINATION TAPPING VALVE

Made of POM



## Design features

- Resilient seated gate valve with smooth straight-through bore
- With conical 2" external thread according to EN 10226 for the clamp attachment and with cylindrical connection thread 1½" according to ISO 228 for connection fitting No. 6221F
- For PE pipes according to EN 12201 and DIN 8074
- One valve with 5 ISO push-fit fittings for PE pipes (pipe Ø 25/32/40/50/63 mm) - reduces stockkeeping!
- A robust valve made of POM
- All parts made of corrosion free materials
- For the easiest under pressure tapping and the quickest installation of ISO push-fit fittings
- Sealing system: the contact between wedge and body is friction free. Therefore no scuffing or abrasion of the wedge

**Standard version:** without handwheel and extension spindle

**Special versions:** on request

**No. 2681**  
**No. 2680**  
**No. 6221F**  
**No. 5940**

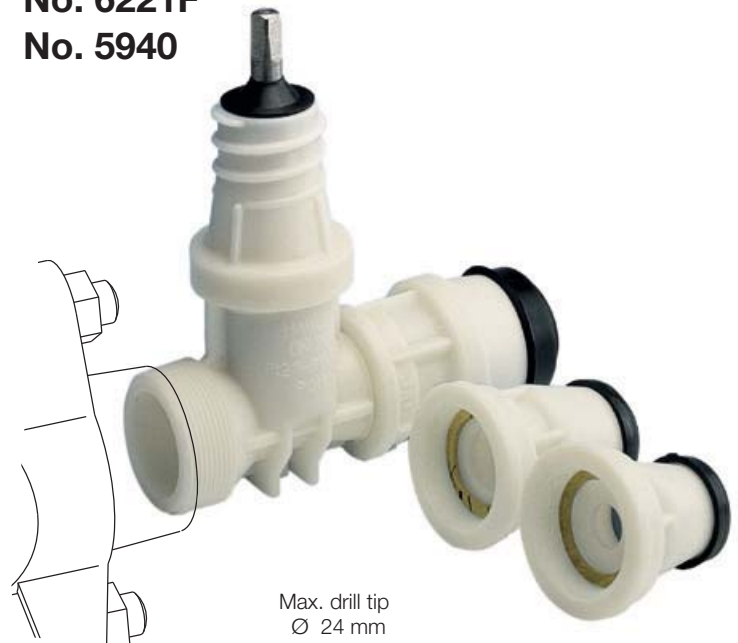

Max. drill tip  
 Ø 24 mm

## Suitable accessories

**Suitable accessories:** see page J 1/2

- |                    |             |                              |
|--------------------|-------------|------------------------------|
| Handwheel:         |             | No. 7800                     |
| Extension spindle: | rigid       | No. 9101                     |
|                    | telescopic  | No. 9601                     |
| Surface box:       | rigid       | No. 1550, No. 1650           |
|                    | telescopic: | No. 1850, No. 1851K          |
| Extension spindle: |             | No. 7820                     |
| Sealing cap:       |             | No. 2156, No. 2157, No. 2158 |
| Chamfering tool:   |             | No. 6000                     |
| Saddle blades:     |             | No. 6010                     |
| Pipe cutter:       |             | No. 6050                     |
| Mounting spray:    |             | No. 3443                     |
| Drilling machine:  |             | No. 5800, No. 5805           |

Order No.	Version	MOP (PN)	DN	Thread	Ø PE-pipe	Weight
2681	ISO Combination tapping valve without fitting	16	1"	2" - 1½"		0,81
						25 0,90
2680	ISO Combination tapping valve with choice of ISO push-fit fitting	16	1"	2" - 1½"		0,94
						40 1,02
						50 1,10
						63 1,23
6221F	ISO push-fit fitting with backing washer	16		1½"		0,10
						32 0,13
						40 0,22
						50 0,29
					63 0,41	
5940	Adapter for Hawle drilling machine 2"			1½" - 2"		1,30



**E. Hawle Armaturenwerke GmbH** 4840 Vöcklabruck - Austria - Wagrainstraße 13  
 Tel.: +43 (0) 7672 72576 0 - Fax: +43 (0) 7672 78464 - E-Mail: hawle@hawle.at - www.hawle.com

**J 5/3**

# ISO COMBINATION TAPPING VALVE

Made of POM



## Tapping valve DN 1"

With 2" external thread EN 10226-1 for mounting onto saddle and

1½" external thread ISO 228 only for ISO push-fit fitting No. 6221F

No. 2681

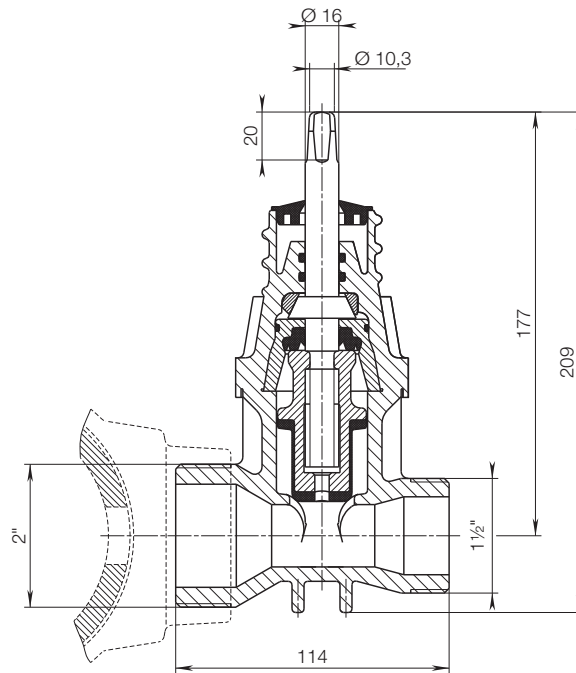

### ISO push-fit fitting No. 6221F

Made of POM  
Internal thread 1½" ISO 228  
Push-fit socket for PE pipes up to PN 16, pipe Ø 25/32/40/50/63 mm  
The flat gasket saves the need for seal

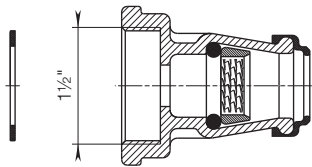

### Adapter No. 5940

Made of bronze  
Internal thread 1½" ISO 228  
External thread 2" ISO 228  
For Hawle drilling machine No. 5800 or No. 5805

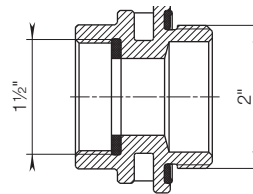

## Drilling and assembly instructions

### 1. Mounting onto the saddle:

Screws the 2" external thread into the internal thread of the saddle

### 2. Drilling:

Open the valve completely; if necessary use adapter (see above)

### 3. Shut-off:

After drilling, retract the drill and close the valve

### 4. Pipe assembly:

Screw on one of the five ISO push-fit fittings - push the pipe in - finished

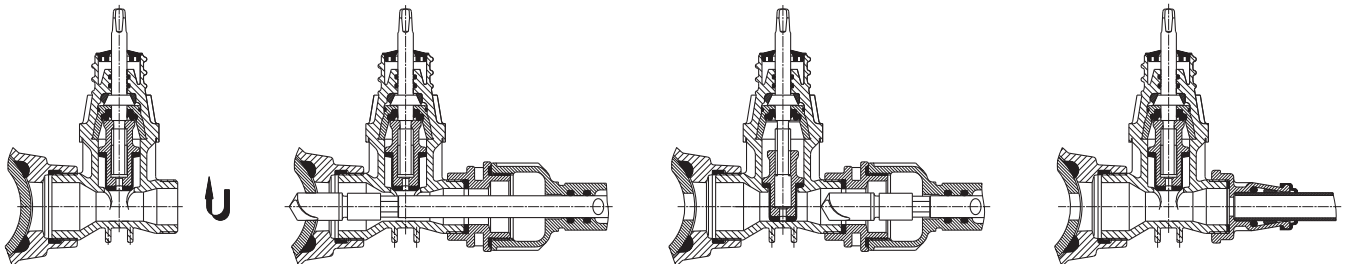

J 5/4



E. Hawle Armaturenwerke GmbH 4840 Vöcklabruck - Austria - Wagrainstraße 13  
Tel.: +43 (0) 7672 72576 0 - Fax: +43 (0) 7672 78464 - E-Mail: hawle@hawle.at - www.hawle.com