

ISO COMBINATION TAPPING VALVE

Made of POM



Design features

- Resilient seated gate valve with smooth straight-through bore
- With conical 2" external thread according to EN 10226 for the clamp attachment and with cylindrical connection thread 1½" according to ISO 228 for connection fitting No. 6221F
- For PE pipes according to EN 12201 and DIN 8074
- One valve with 5 ISO push-fit fittings for PE pipes (pipe Ø 25/32/40/50/63 mm) - reduces stockkeeping!
- A robust valve made of POM
- All parts made of corrosion free materials
- For the easiest under pressure tapping and the quickest installation of ISO push-fit fittings
- Sealing system: the contact between wedge and body is friction free. Therefore no scuffing or abrasion of the wedge

Standard version: without handwheel and extension spindle

Special versions: on request

No. 2681
No. 2680
No. 6221F
No. 5940

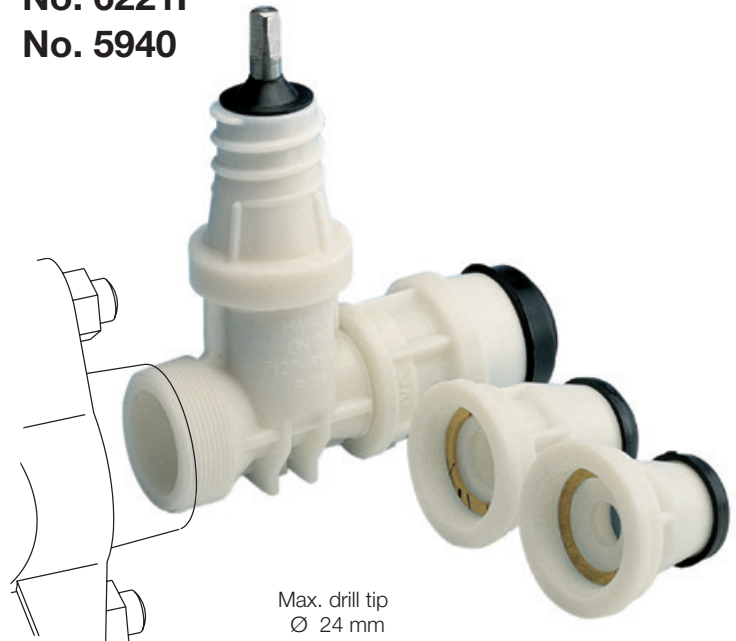

Max. drill tip
 Ø 24 mm

Suitable accessories

Suitable accessories: see page J 1/2

Handwheel:		No. 7800
Extension spindle:	rigid	No. 9101
	telescopic	No. 9601
Surface box:	rigid	No. 1550, No. 1650
	telescopic:	No. 1850, No. 1851K
Extension spindle:	No. 7820	
Sealing cap:	No. 2156, No. 2157, No. 2158	
Chamfering tool:	No. 6000	
Saddle blades:	No. 6010	
Pipe cutter:	No. 6050	
Mounting spray:	No. 3443	
Drilling machine:	No. 5800, No. 5805	

Order No.	Version	MOP (PN)	DN	Thread	Ø PE-pipe	Weight
2681	ISO Combination tapping valve without fitting	16	1"	2" - 1½"		0,81
2680	ISO Combination tapping valve with choice of ISO push-fit fitting	16	1"	2" - 1½"	25	0,90
					32	0,94
					40	1,02
					50	1,10
					63	1,23
6221F	ISO push-fit fitting with backing washer	16		1½"	25	0,10
					32	0,13
					40	0,22
					50	0,29
					63	0,41
5940	Adapter for Hawle drilling machine 2"			1½" - 2"		1,30



E. Hawle Armaturenwerke GmbH 4840 Vöcklabruck - Austria - Wagrainstraße 13
 Tel.: +43 (0) 7672 72576 0 - Fax: +43 (0) 7672 78464 - E-Mail: hawle@hawle.at - www.hawle.com

J 5/3

ISO COMBINATION TAPPING VALVE

Made of POM



Tapping valve DN 1"

With 2" external thread EN 10226-1 for mounting onto saddle and

1½" external thread ISO 228 only for ISO push-fit fitting No. 6221F

No. 2681

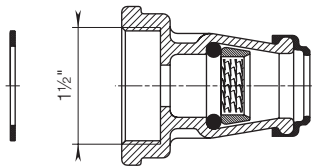
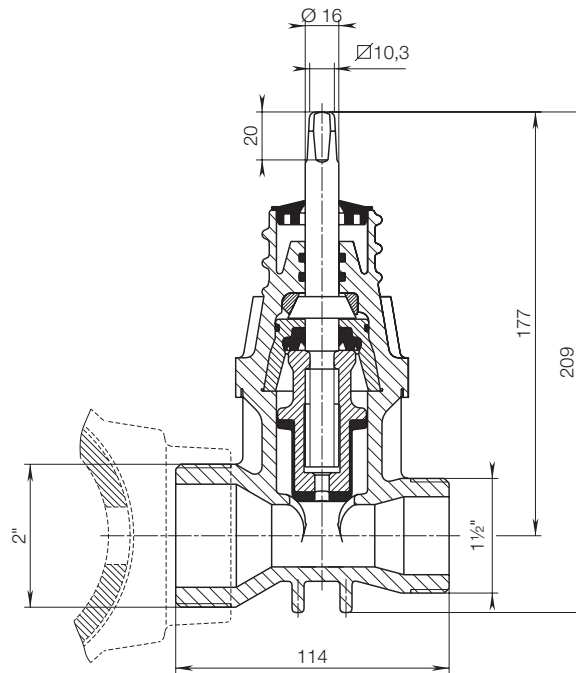

ISO push-fit fitting No. 6221F

Made of POM
Internal thread 1½" ISO 228
Push-fit socket for PE pipes up to PN 16, pipe Ø 25/32/40/50/63 mm
The flat gasket saves the need for seal

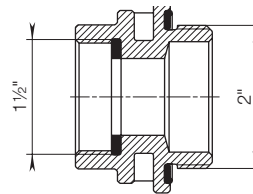

Adapter No. 5940

Made of bronze
Internal thread 1½" ISO 228
External thread 2" ISO 228
For Hawle drilling machine No. 5800 or No. 5805

Drilling and assembly instructions

1. Mounting onto the saddle:

Screws the 2" external thread into the internal thread of the saddle

2. Drilling:

Open the valve completely; if necessary use adapter (see above)

3. Shut-off:

After drilling, retract the drill and close the valve

4. Pipe assembly:

Screw on one of the five ISO push-fit fittings - push the pipe in - finished

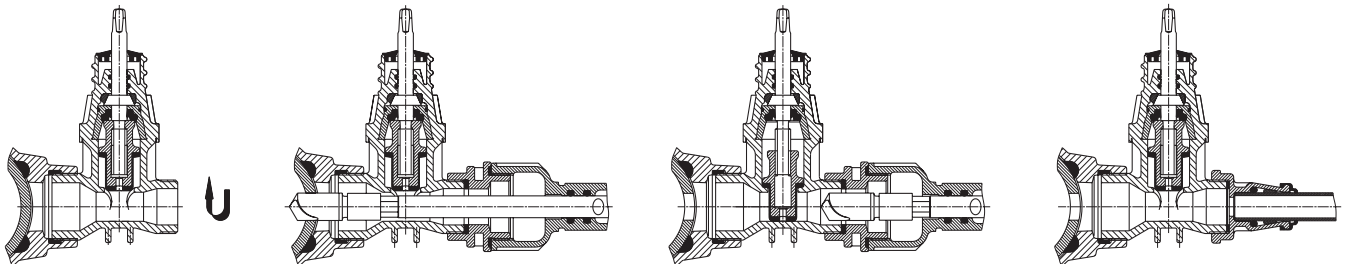

J 5/4



E. Hawle Armaturenwerke GmbH 4840 Vöcklabruck - Austria - Wagrainner Straße 13
Tel.: +43 (0) 7672 72576 0 - Fax: +43 (0) 7672 78464 - E-Mail: hawle@hawle.at - www.hawle.com