

Datablad

Altech kanalfiltre



Description

F-STR duct filters are designed for installation at the point of connection between round ducts and ventilation fittings. The conical filter element form provides better filtration efficiency and reduces the pressure loss across the filter. The standard filtration class is EU4 or EU5. The maximum operating temperature is 120 °C.

Maximum recommended flow velocity:

class EU3 — V = 14 m/s
 class EU4 — V = 10 m/s
 class EU5 — V = 4.5 m/s

Product code example

Product code: F-STR - aaa - E4

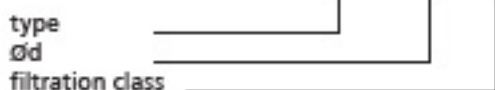

Dimensions

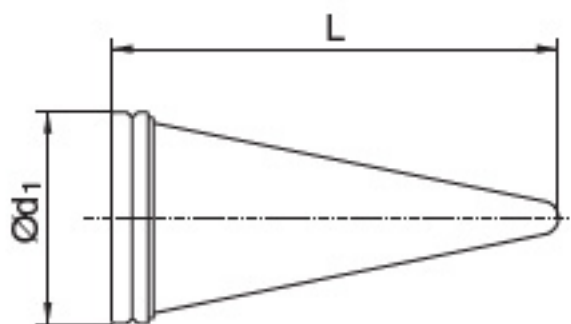

| Ød _{max} (mm) | L (mm) | Surface area (m ²) | Weight (kg) |
|---------------------------|-------------|-----------------------------------|----------------|
| 100 | 220 +/- 20 | 0.04 | 0.03 |
| 125 | 260 +/- 20 | 0.05 | 0.05 |
| 160 | 340 +/- 20 | 0.08 | 0.09 |
| 200 | 420 +/- 25 | 0.13 | 0.13 |
| 250 | 540 +/- 30 | 0.22 | 0.21 |
| 315 | 670 +/- 30 | 0.36 | 0.33 |
| 400 | 960 +/- 35 | 0.55 | 0.54 |
| 500 | 1100 +/- 50 | 0.69 | 0.96 |
| 630 | 1350 +/- 50 | 1.37 | 1.34 |

Technical specifications

Pressure loss:

It is highly recommended that the total final pressure loss should be set at: $P_k = 1.5P_t$ — check the value of P^* in the charts below.

EU3 filtration class

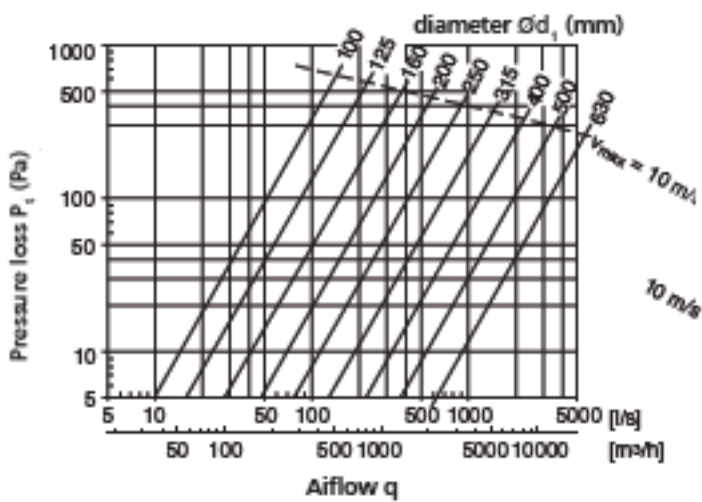

EU5 filtration class

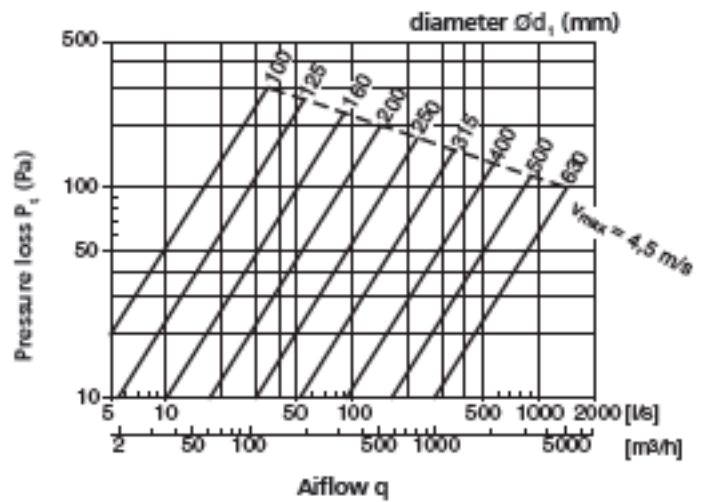

EU4 filtration class

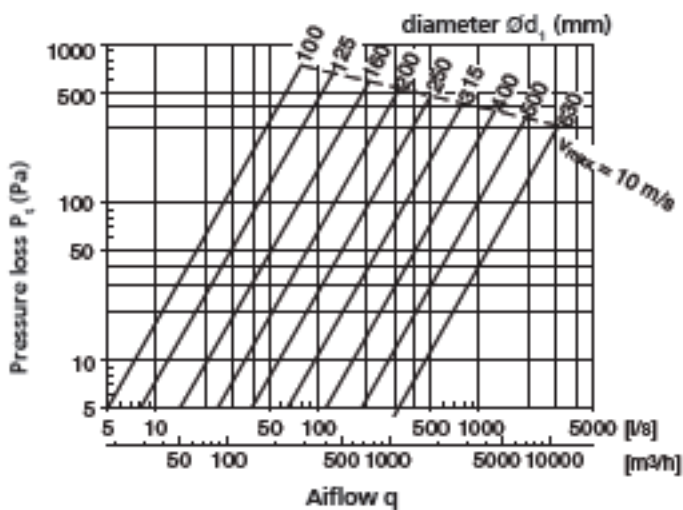

Kontaktinformation

For yderligere information kontakt din lokale butik eller Brødrene Dahls Klimacenter på telefon nr 48 78 56 66.